

50-B-62 - SPEEDLINE System Data Sheet - Version V1 (24-10-23)

SPEEDLINE 50mm 'C' Stud Partition @600mm Ctrs,
with 2x BG Gyproc 15mm FireLine each side

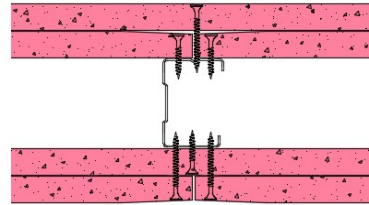

System Performance Breakdown

Fire Resistance:

BS476 Part 22:1987:

Test Ref & Date or Applied Ref & Report:

Max Height:

Thickness:

Duty Grade: BS 5234: Part 2:1992:

Sound Insulation:

120/120 Minutes (Integrity/Insulation).

BTC 17442F - BRE Report P102396-1011A

Refer to Speedline Specification Clause

112 mm. (At Base Track, Excluding Finishes)

Severe - Annexes A-F

45 $R_{w,dB}$, Date Tested or Assessed Against - 50-B-58

Test Code:
H17479AA
Test Date:
13/07/2011

Freq. Hz	R dB
50	27.9
63	17.0
80	14.8
100	15.6
125	22.2
160	28.9
200	37.4
250	37.5
315	38.7
400	43.9
500	49.2
630	50.3
800	54.0
1 000	55.3
1 250	56.9
1 600	57.5
2 000	48.8
2 500	44.1
3 150	48.0
4 000	52.7
5 000	53.8
6 300	
8 000	
10 000	

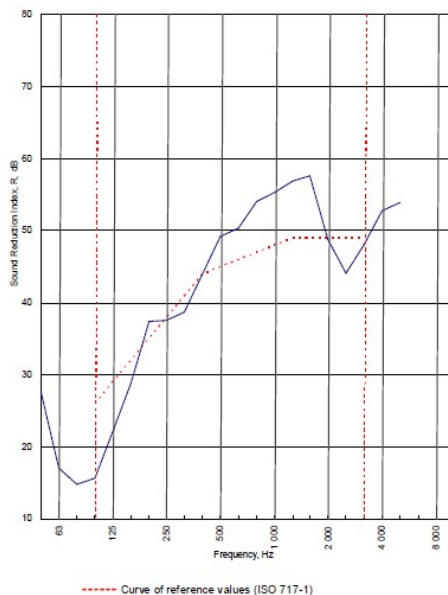

Rating according to BS EN ISO 717-1:1997	R_w (C;Ctr) = 45 (-4;-11) dB		
Evaluation based on laboratory measurement results obtained by an engineering method:	$C_{50-3150}$ = -5 dB	$C_{50-5000}$ = -4 dB	$C_{100-8000}$ = -3 dB
	$C_{50-3150}$ = -14 dB	$C_{50-5000}$ = -14 dB	$C_{50-8000}$ = -11 dB

TESTED AT ONE OF THE UKAS ACCREDITED LABORATORIES BELOW

B.T.C (H-Ref on Graph)

B.R.E

AIRO

S.R.L

Customer: Metsec plc Hepsec Division



BTC 17479A: Page 8 of 10

SPEEDLINE Drywall Systems, Adsetts House, 16 Europa View, Sheffield Business Park, Sheffield, S9 1XH.

Tel: 0114 231 8030.

Email: enquiries@speedlinedrywall.co.uk

(As per the requirements set out in ISO/IEC 17025:2017 regarding test data the results stated have been carried out by voestalpine Metsec plc as part of the contract to supply Speedline Metal Sections to SIG Plc)